

- Adjusts to any angle from flat to vertical
- Integrated mast holds canvas up to 71" high
- Weighs 22 lbs. with two oversized wheels

Scan QR code to view instructional video.



Parts & Hardware

Carefully check contents of box to ensure no parts are missing.



Brass Plate x 3

Bolt Assembly x 2



Wheel x 2

Assembly Details

Carefully review all steps before proceeding.

STEP 1 Separate each **bolt assembly** and attach each **wheel** to the outside front of the **base** in the order shown below.

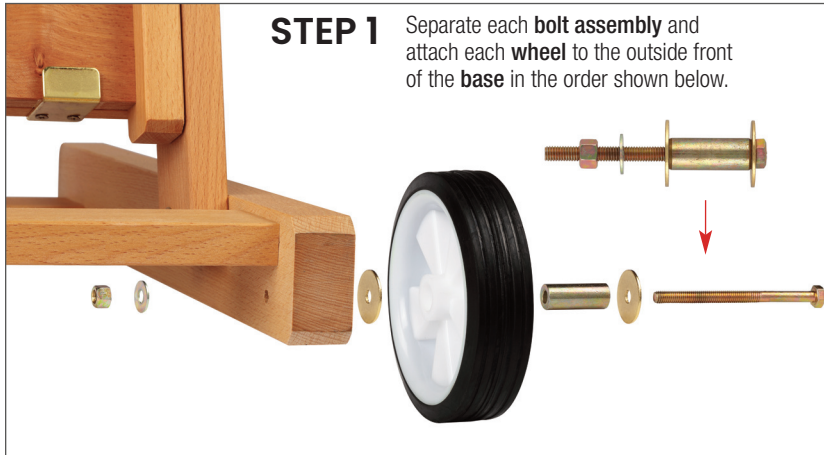

STEP 2 Insert a **brass plate** into the two holes located in the center groove at the top of the **base** assembly. Then, slide the **mast** down into the groove at the top of the **base**.

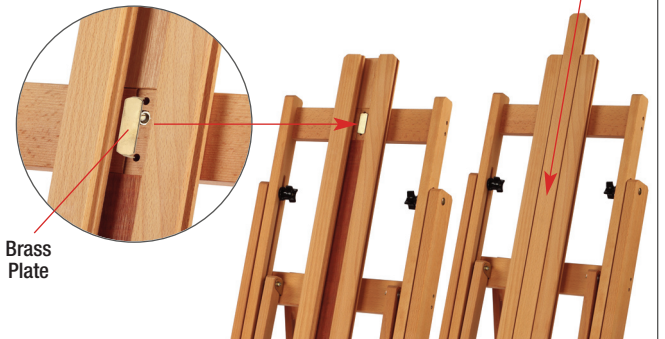

STEP 3

Insert a **brass plate** into the holes on the back of the **bottom canvas support** then slide onto the **mast** assembly from the top, sliding to the bottom, then tighten in place using the front knob.

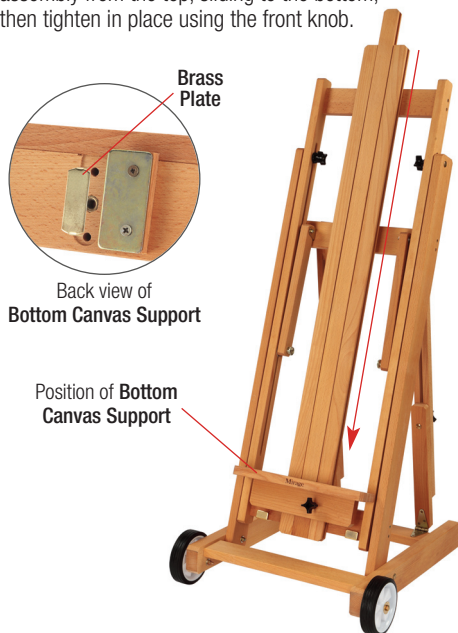

STEP 4

Insert a brass plate into the back of the **center canvas support**, slide into center position, and tighten knob.

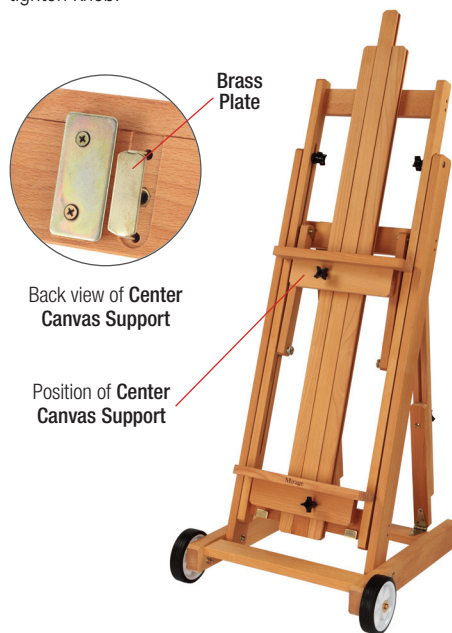

STEP 5

Repeat for the **top canvas support**. Tighten all knobs to preferred settings.

